

first floor

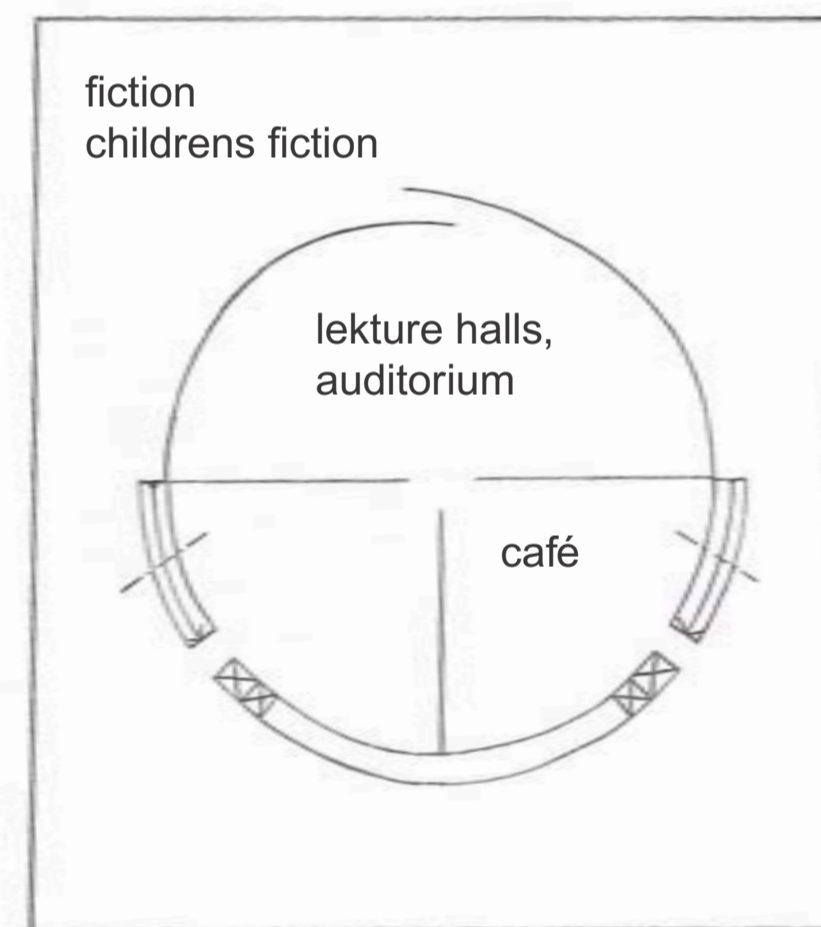

second floor

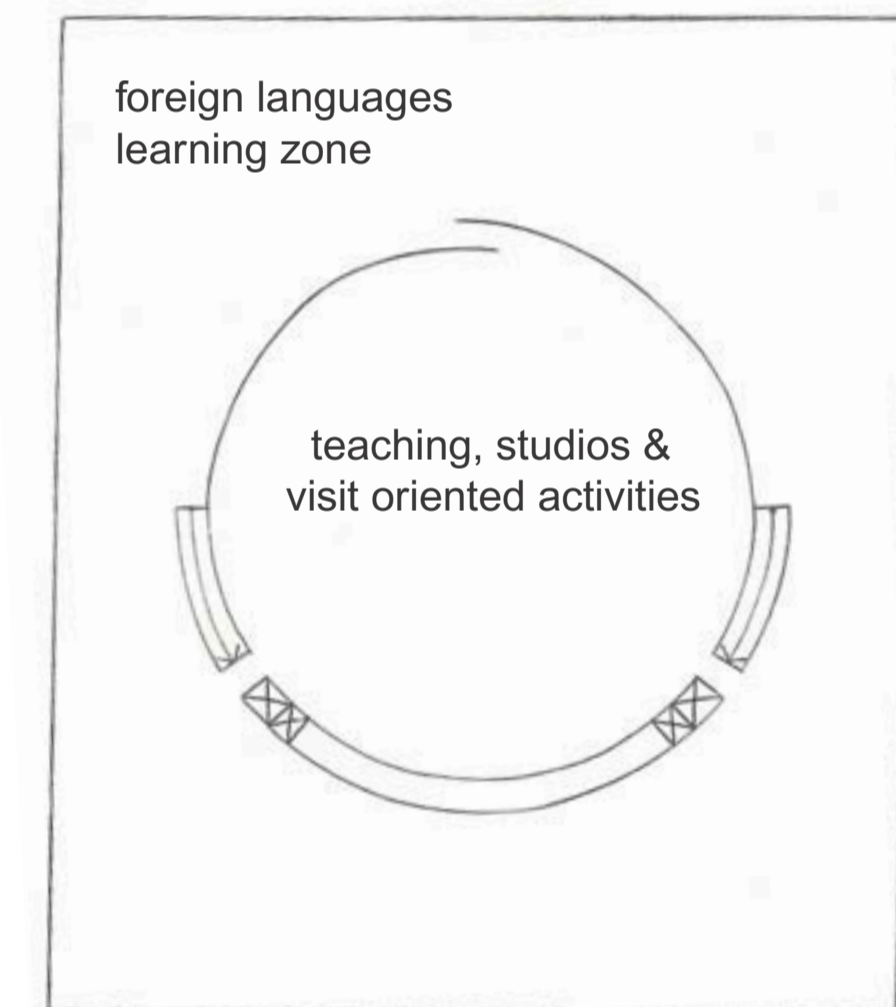

third floor

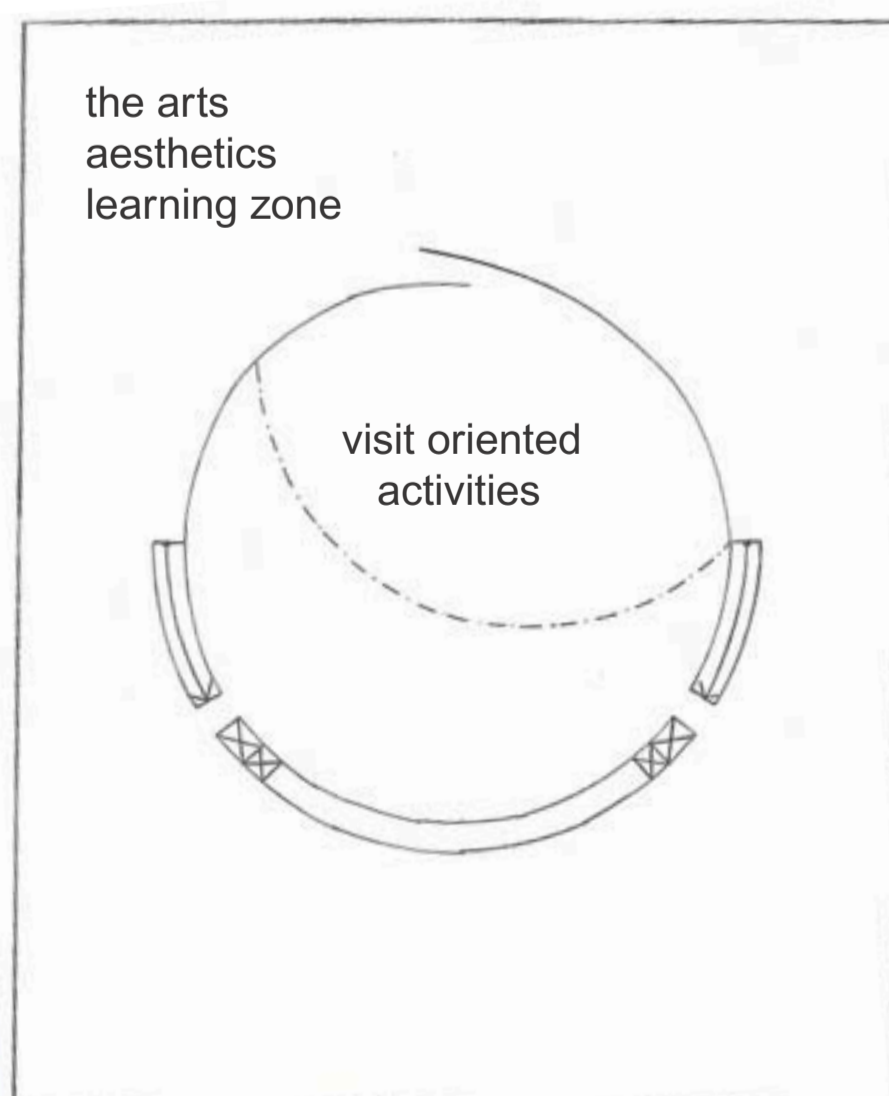

top floor

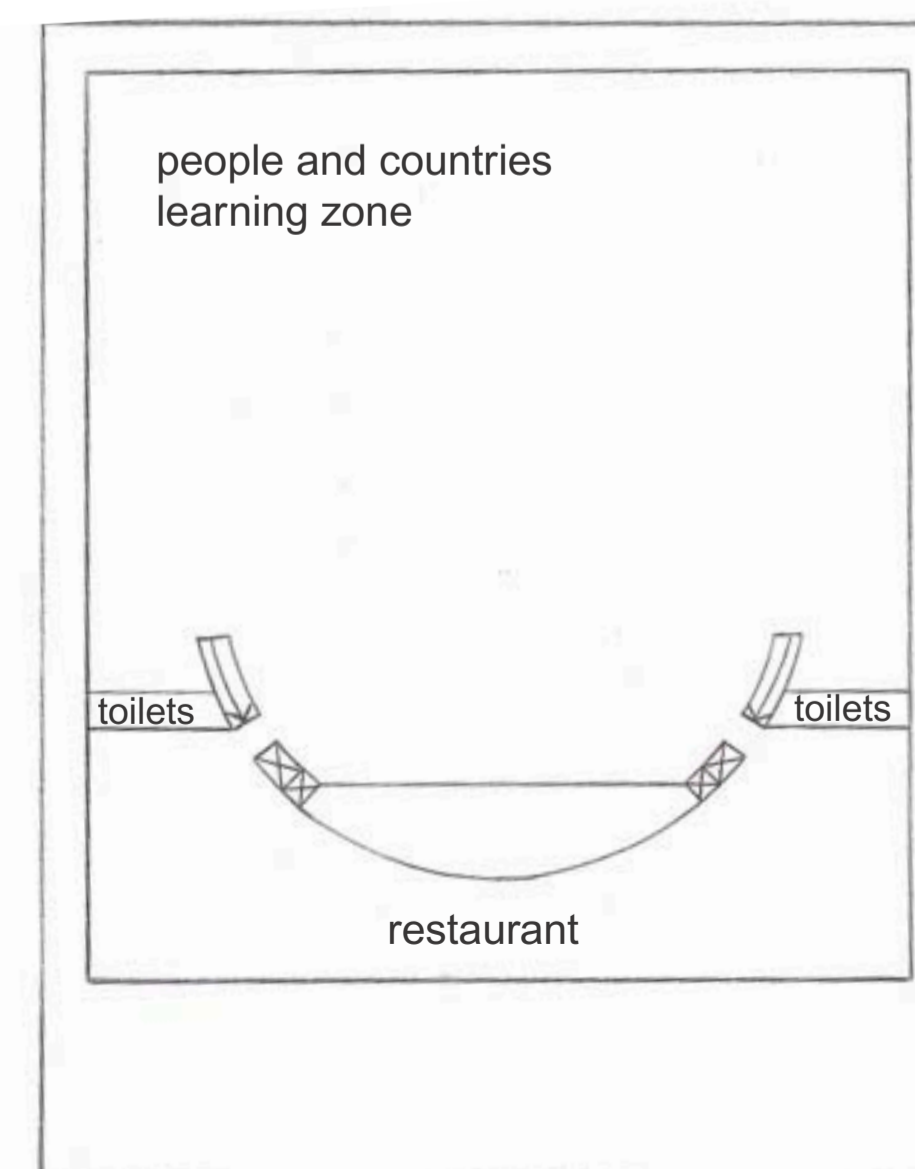

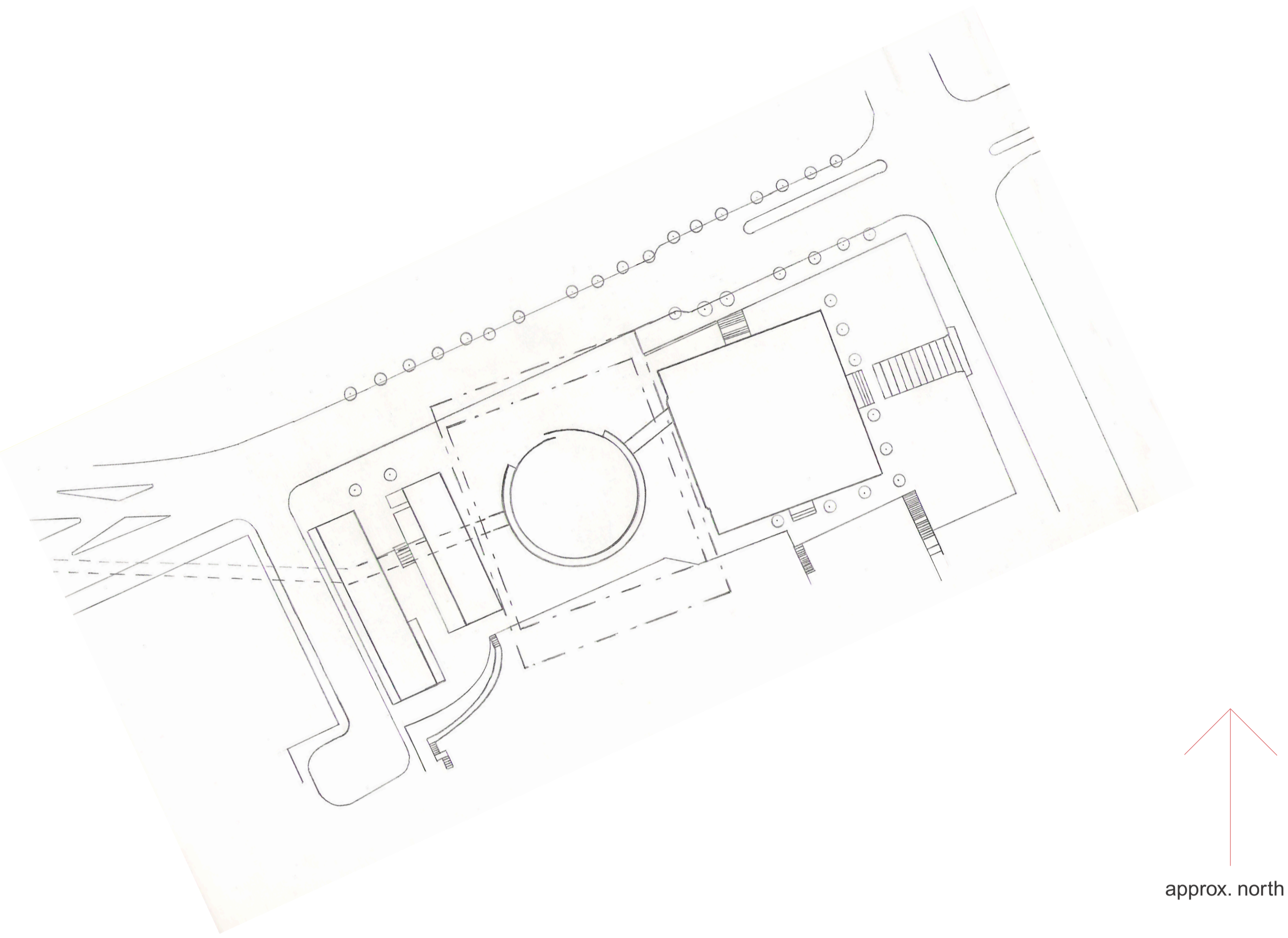

When I first saw the Asplund building, I felt like tipping it, turn it upside down and mess it all up, just because it's so perfect. So I thought: why not! That finished shape needs something tough, something completely different. Still there has to be a connection between new and old.

The idea of a library has always been to supply the people with knowledge. It still is, but today it works different and it has other functions too. It is a place to meet, to relax, to create and to enjoy yourself. The people and their interests are as important as old books. That's why we are going to create a library that is inviting, interesting fascinating and alive! From the first sight to the last footstep.

The new library will consist mostly of open areas, where you can find inspiration in everything: art, the view, the books, music, internet or people. The learning zones will exist in every part of the library, allowing you to find your own quiet corner or lively space for your work.

The entrance, and the open space in front of it, will be a melting-pot for activities, news, plays, meeting with friends, exhibitions, coffee breaks, happenings, fashion shows, anything!

The big glass front, facing Odengatan, is the big Display. A perfect showroom for "what's on"-s, art, projects or advertising. With all the new technology coming up I am sure you can find other functions too; projections, giant screen TV, you name it!

The many glass areas could also be lightened up in different colours to fit in, stick out or to get lost in the environment, night or day, summer or winter, by mood or weather. Maybe they could be coloured as the Swedish flag on the national day.

I love the restaurant with its roof terrace where you can have a romantic dinner while the sun is setting in the west, or a Sunday brunch with your best friends. If the library is closed, just take the lift from outside.

The Asplund building will host civic studies, nature and technology and most of the staff. The Swedish Institute of Children's Books will, if possible, continue their business in the Annex2. In Annex1 we will find sorting machines and media management, logistics center, caretakers offices and property services.

The buildings are very close to each other by many reasons. It creates a feeling of whole and belonging, caring and safety, which is important.

Another thing I should mention is my removing of the third annex building. The new building will be of greater value to the people than the old building. Though the annex were beautiful it was not good for its function. The new library will be custom made for today's needs and it will add to the importance of a mixed city centre, with new and old in balance. The shape is, as I mentioned, a distortion of the Asplund building, but what I saw in my mind was also a bird flying from his nest, facing the world, facing the knowledge.

MUA ca. 25000m² (new: 13700m²)
gross area (the new building): ca. 16000m²

15 minutes of engagement