

Brief
The aim of this competition is to design a new combined arts building next to the existing Kulturmagasinet. The requested programme counts approximately 12000m² of cultural functions to be placed in a landmark like building.

City
The City of Sundsvall lies halfway the east coast of Sweden, overlooking the Sundsvall fjord. The citycentre has a grid shaped urban structure. This grid structure is supported by a sequence of urban parks and squares.

Location
The proposed location is a landfill. The property is enclosed by the existing Kulturmagasinet, the soon to be moved E4 highway, and the river. The location is situated at the head of the Sundsvall fjord, and has a magnificent view over it. The existing Kulturmagasinet is a cluster of former industrial warehouses. The old buildings are constructed in brickwork. The space inbetween the buildings is covered with a glass structure. This way the different buildings are connected to form one big building.

Concept
The idea is to leave the existing Kulturmagasinet mostly like it is and to create a freestanding new building with an identity of its own. The base of the new building stays within the boundaries of the existing urban block structure. Both buildings will have its own main entrances and are to be connected by an underground corridor. In the space between the buildings a new park will be added to the city's green system. The positioning of the new building in the citygrid allows place for other new buildings around the site to also be placed according to this grid. The best quality of the plot is the possible view over Sundsvall and the fjord. To be able to see something of this, people have to be transported to a higher position. The heart of the building is to be formed by an elevated square looking over the roofs and bay of Sundsvall. This square completes the city's system of public squares. From here people can explore the new building. This way it looks like visitors are being dropped into a huge silo from above.

Kultur Silo
The new building exists of different parts:

1. (ELEVATED SQUARE = FOYER) The new building is to be entered by taking the huge escalators from the square inbetween the old and new building. Once upstairs people can enjoy the view over Sundsvall. This level is the main foyer of the building. Here we find the restaurant, box office, cloakroom, and sun deck. From here people can start to explore the building. Going up means going to the workshop area, going down means going to a theatre show.
2. (SILO = THEATRE) The lower part of the building exists of a base housing the stage towers, and vertical infrastructure. This volume adapts to the existing urban lay-out of the city. Outside of this volume the auditoriums are glued to the building as autonomous objects.
3. (APPLIED ARTS / ADMINISTRATION) This two storey block floats above the elevated square. The block houses one floor of workshop areas, and one floor of administrative functions. These functions are placed behind glazed walls at the centre of the floors. This way all people can have a undisturbed view over Sundsvall from inside and outside the hallways.
4. (VENTILATION BOX) The black ventilation box is placed on top of the building.
5. (PARKING) From the square between the two Kultur buildings big steps descend the ground to enter the underground corridor and garage. The parking is arranged in 2 storeys and counts about 500 spots.
6. (CORRIDOR) The Kulturmagasinet and the Kultursilo are connected by a heated underground corridor. From the main hall in the Kulturmagasinet a monumental staircase descends the ground. From here people can walk to the elevators belonging to the Kultursilo. This corridor houses the exhibition space and the large glazed facade of the entrance of the garage provides for lots of daylight.

The appearance of the new building is like a modernist industrial warehouse / factory. The applied materials express the underlying function. Main materials used are glass in different shades and opacities, polycarbonate and aluminium cladding.

The construction of the building is hybrid. A combination of multiple storey high steel girders and concrete towers allow us to stack construction spans in different directions.

Public Space.
The E4 highway will soon be relocated. However the road will still be a mayor block for the site. For the space around the building we propose to partly excavate the site. This way the new E4 will be a free structure over the fjord.

Sundsvall lies way up north and knows only a limited amount of sun hours. This way the public space around the building knows an extensive materialisation. The main material is black asphalt combined with spots of granite flagstone. The heart of the square is slightly lifted and clad with a perforated corten-steel plating. Inside of this perforation a grid of Birch trees is planted. The middle of this corten strip is lifted to provide for a spacious entrance of the parking garage and corridor. The edges of the square disappear into the fjord and can be used as boat slopes. On top of the square several concrete blocks are placed. These blocks can be used to sit on. White glass boxes house emergency escapes from the underlying parking garage. In the back wall of auditorium one's backstage a system of large doors provides for an opportunity to organise an outdoor theatre play. In front of the doors a large hill is erected to provide for a place to sit on. This hill is paved in the same material as the rest of the square. From here it is also possible to enter the back / star entrance of the Kultursilo.

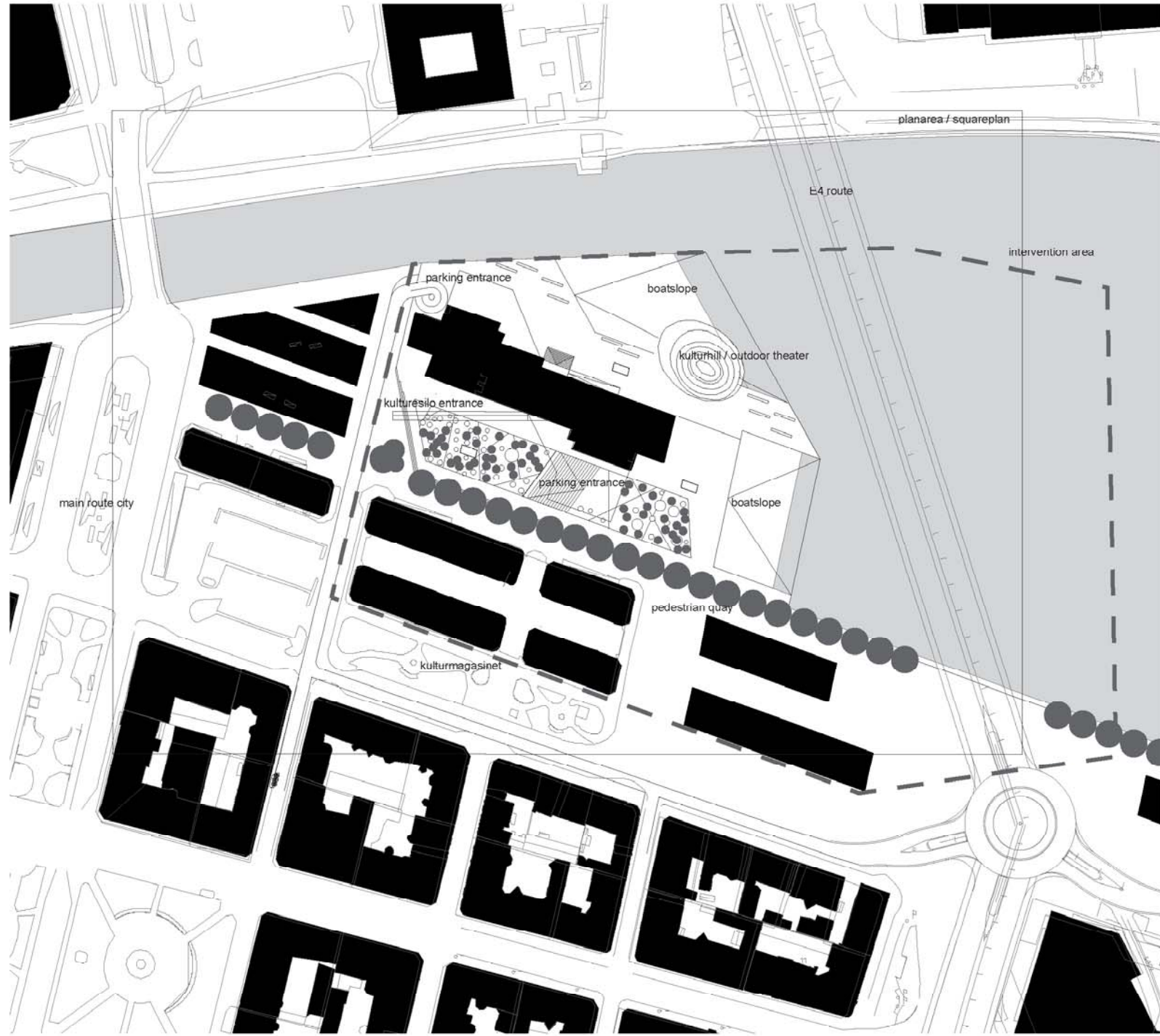

1/1000
SITE PLAN

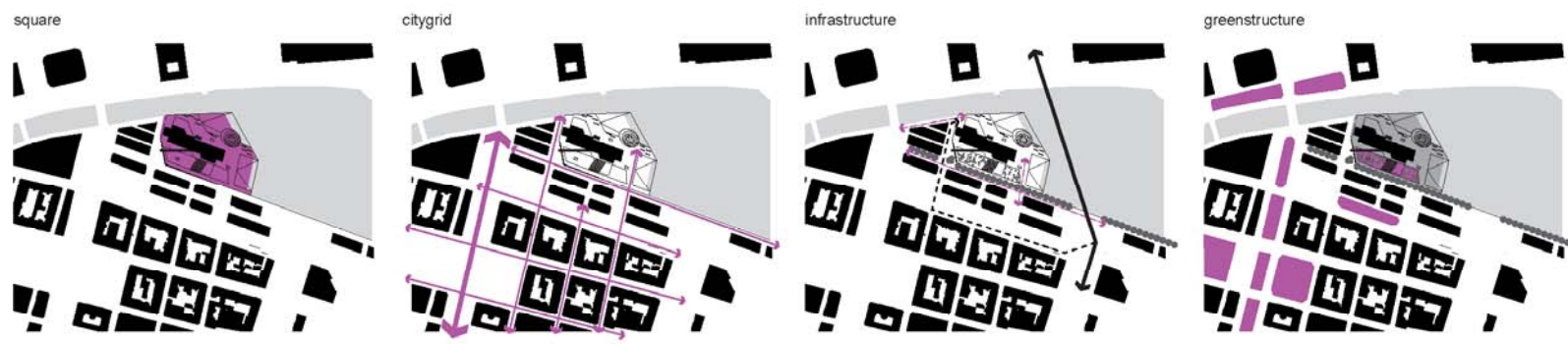

1 Kultur Silo



0 10 20 30 40 50
 1/800
 basement parking / corridor kulturmagasinet-kultursilo - 3000mm

0 5 10 15 20 25
 1/400
 PLAN AREA / GROUND FLOOR +2000 ARTS CENTRE

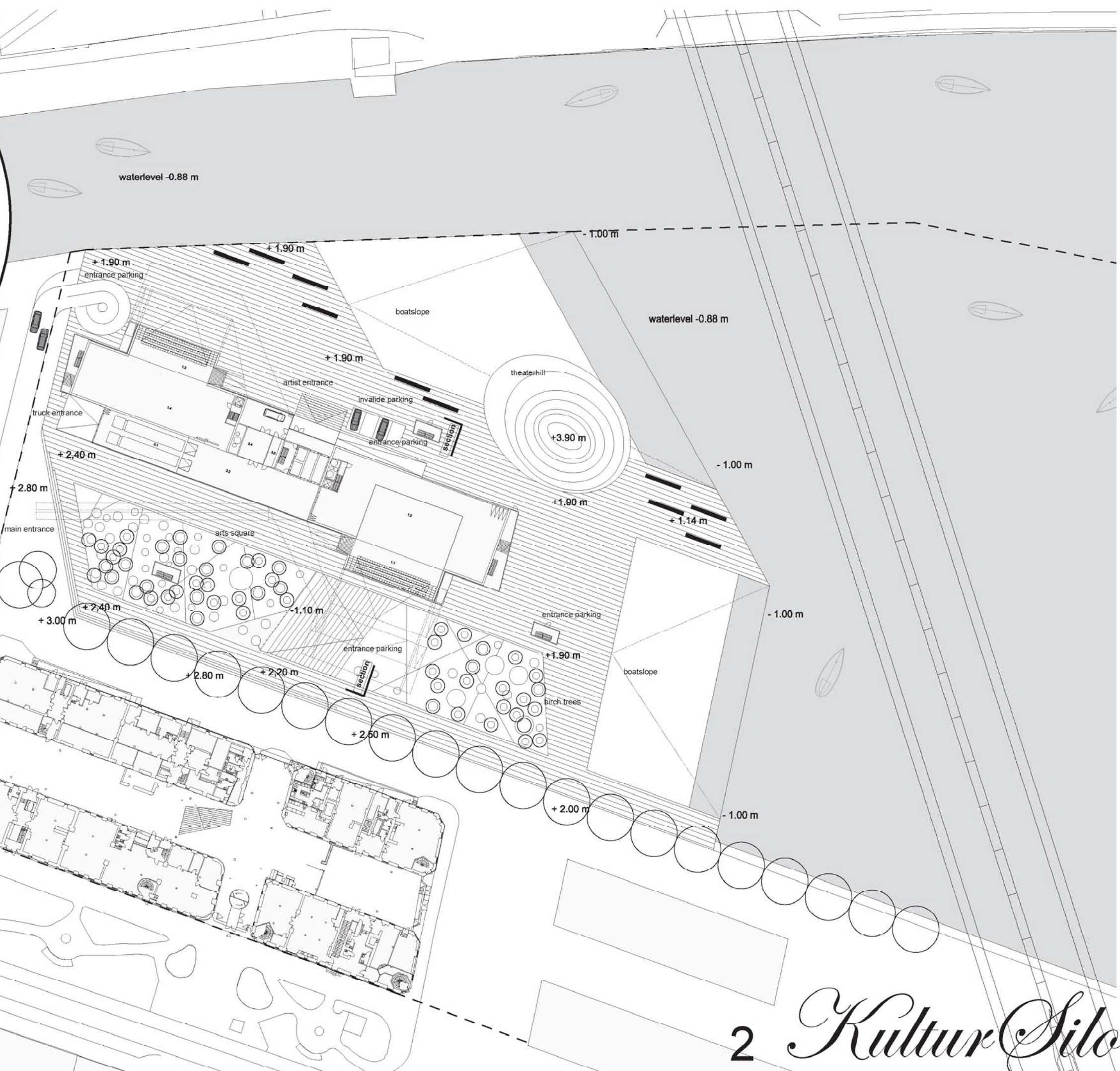

2 Kultur Silo

